

SMARTRACING™ PRODUCTS

A Company Developing Smart Racing
Products Through Engineering

Shock Removal From Strut

Instructions Shock Removal From Strut

The following illustration shows how to remove the shock insert from the strut itself. If you are sending us just the shock insert to be revalved, there isn't any reason to send the entire strut and insert - it just costs more to ship and we'll also have to charge you the labor to disassemble and then reassemble the struts.

Removing: Using a 6mm flat nosed round drift, tap the roll pin all the way out of the shock body. Pull the insert out of the body and wipe it clean.

Installing: Carefully slip the bump stop over the insert's shaft (see the tech sheet for shortening the bump stop if applicable). Lube the shaft with the appropriate light grease and carefully install the insert into the strut body. Watch through the 6mm roll pin hole for the shaft to come through. When you see the half-round groove line up with the 6mm hole, tap the roll pin in place. Be sure the split on the roll pin is against the strut body, not the shock shaft. The roll pin is properly installed when the roll pin protrudes evenly on both sides of the strut body.

If you have any questions, just call!

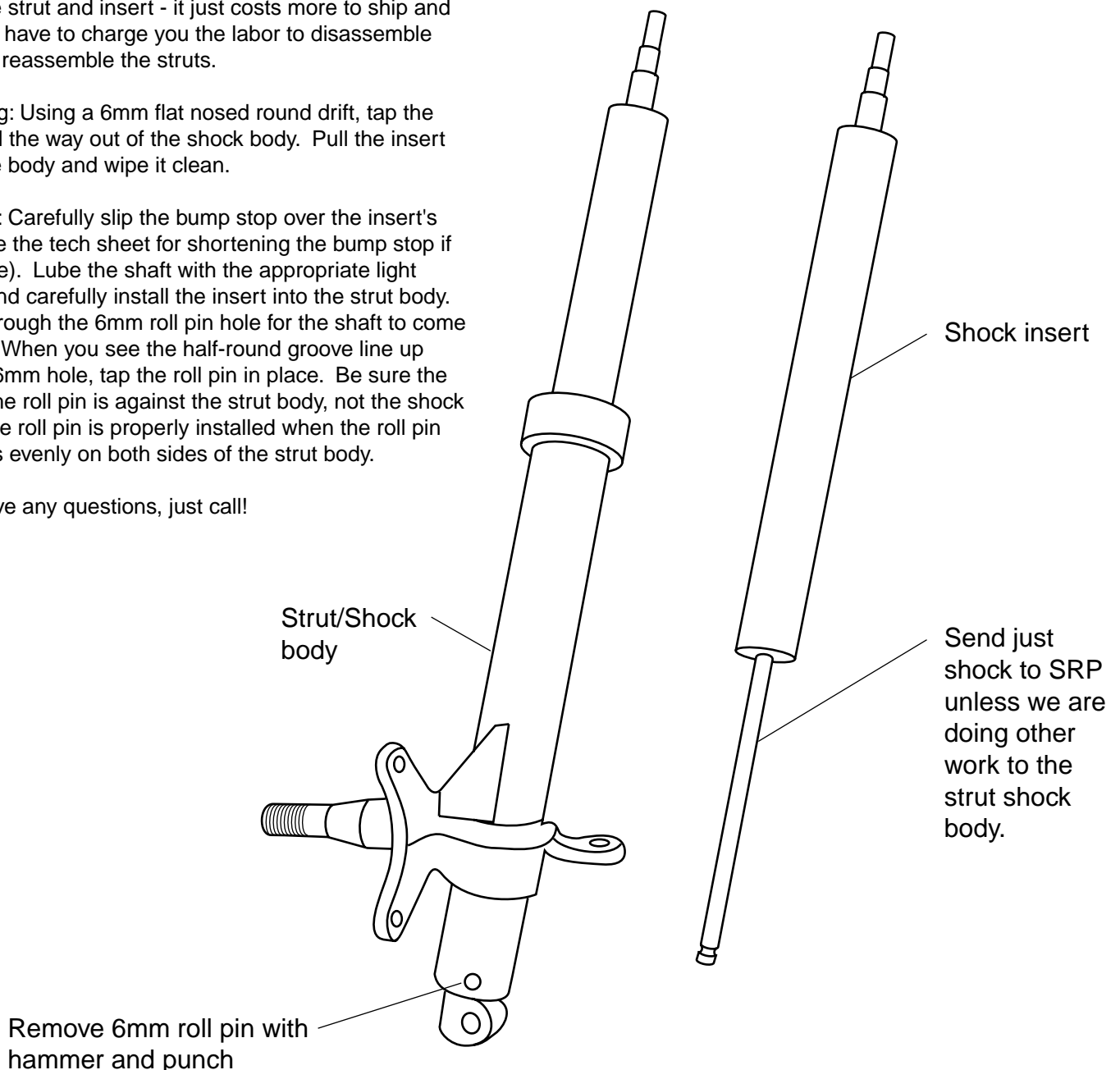

Questions or comments please call 408.369.9997 or FAX 408.369.9915
www.smartracingproducts.com