

# SMARTRACING™

## PRODUCTS

A Company Developing Smart Racing  
Products Through Engineering

Factory Bump Stop Modification

## Instructions Front Factory Bump Stop Modification

The following illustration is to provide you with a visual of how the factory bump stops (rubber) are installed on the front struts on '89 and earlier 911's. This is a very important to know because if you lower the car beyond a certain point, the inserts will bottom out on the bump stop and send the spring rate through the roof, which usually ends up making the car push or exhibit inconsistent (and sometimes baffling) handling characteristics.

The illustration shows before and after shortening of the bump rubber itself. To remove the insert from the strut, just tap out the 6mm roll pin near the bottom of the strut body. Shorten the bump and reinstall it. While reinstalling, make sure the split in the roll pin is not against the shock insert, but rather, against the strut bore. This will keep the insert from pounding out the roll pin and loosening it.

Any questions, just call!

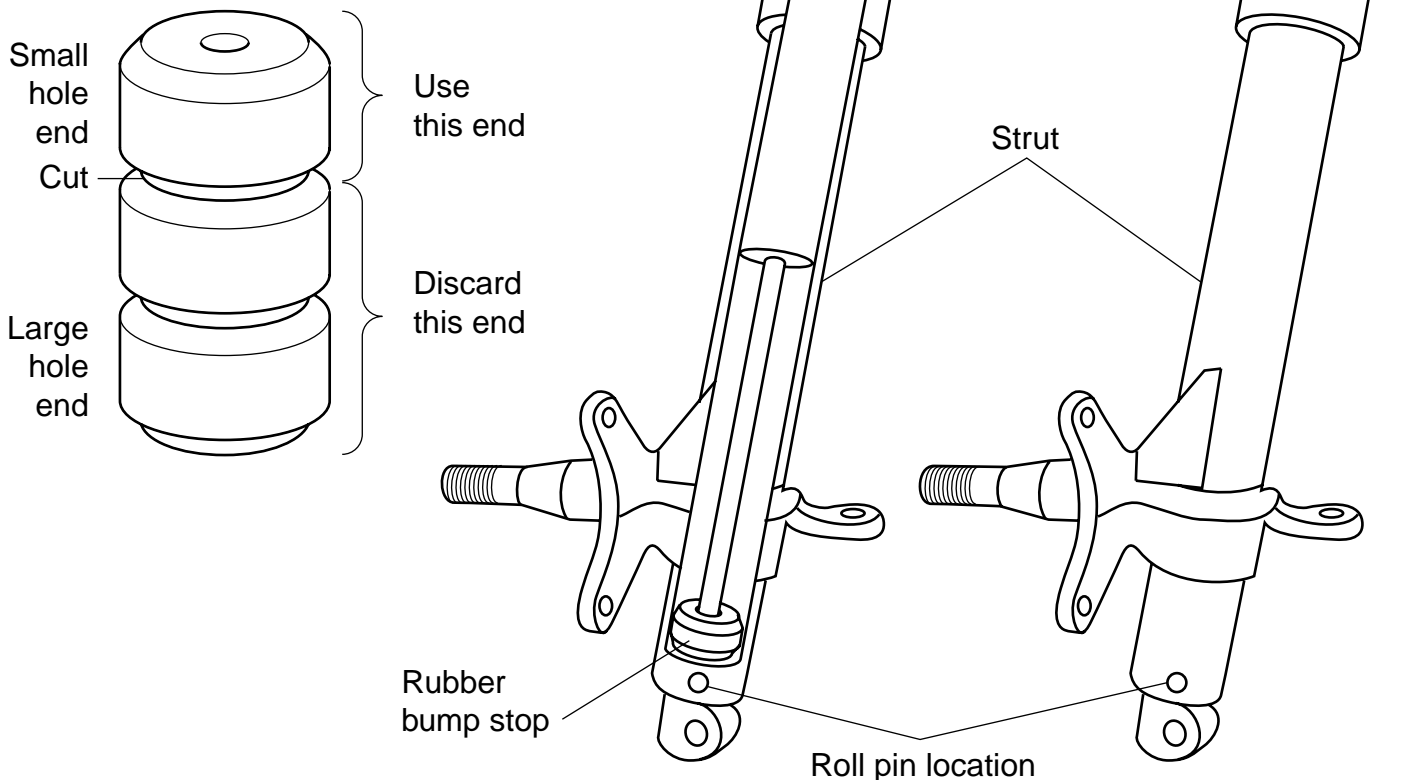

Questions or comments please call 408.369.9997 or FAX 408.369.9915  
[www.smartracingproducts.com](http://www.smartracingproducts.com)