

SMARTRACING™ P R O D U C T S

A Company Developing Smart Racing
Products Through Engineering

Horn Ring Adapter – Part No. 722200

It has come to our attention that the horn adapter kit height can vary. Check that your screws protude through the back of the adapter ring. If yours do not, replace them with the longer 5m x 25m screws supplied with this notice.

Quick Release Horn Ring Steering Wheel Adapter Assembly Sequence for Momo™/Sparco™ Steering Wheels

Installation

Remove the steering wheel from the Quick Release. Place the spacer on the Quick Release (make sure the chamfer side is facing you) followed by the horn ring. Now position the steering wheel and install the six 5m x 25m screws (provided with the adapter) use blue Loctite and titan to 49 in-lbs (5.6 Nm). Hook up the wires to the button ring and install button.

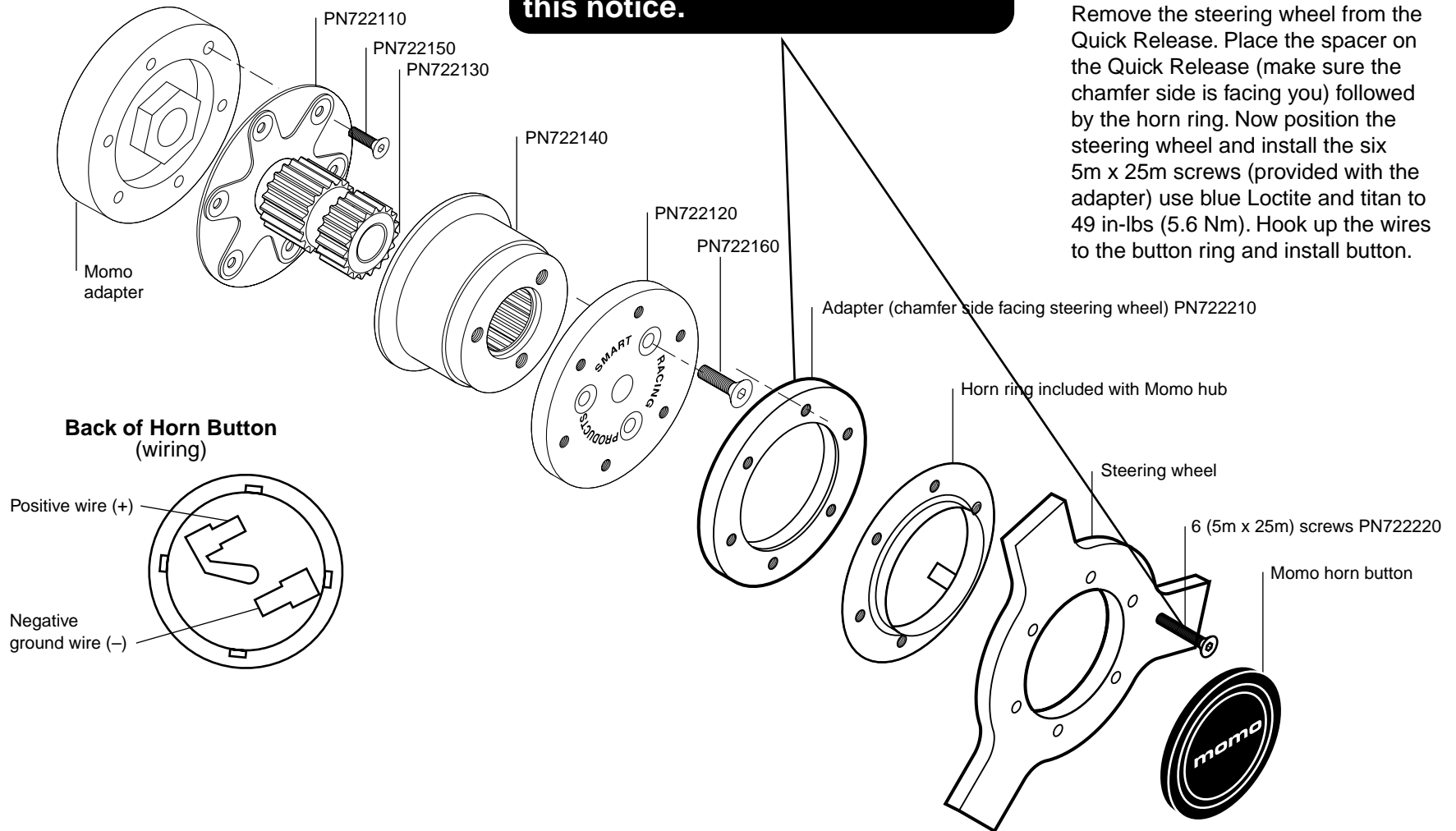

Questions or comments please call 408.369.9997 or FAX 408.369.9741
email@smartracing.net www.smartracing.net