

SMARTRACING™ PRODUCTS

A Company Developing Smart Racing
Products Through Engineering

911 OIL INLET ADAPTER KIT
-16 Part No. 155150
-20 Part No. 155160

911 OIL INLET ADAPTER KIT -16 Oil Line -20 Oil Line

Notes:

- 1) If oil filter plate is not installed a spacer ~10mm thick must be installed on the right stud.
- 2) We strongly suggest you install the oil filter plate and filter.
- 3) Torque all fasteners to 14 ft-lbs.

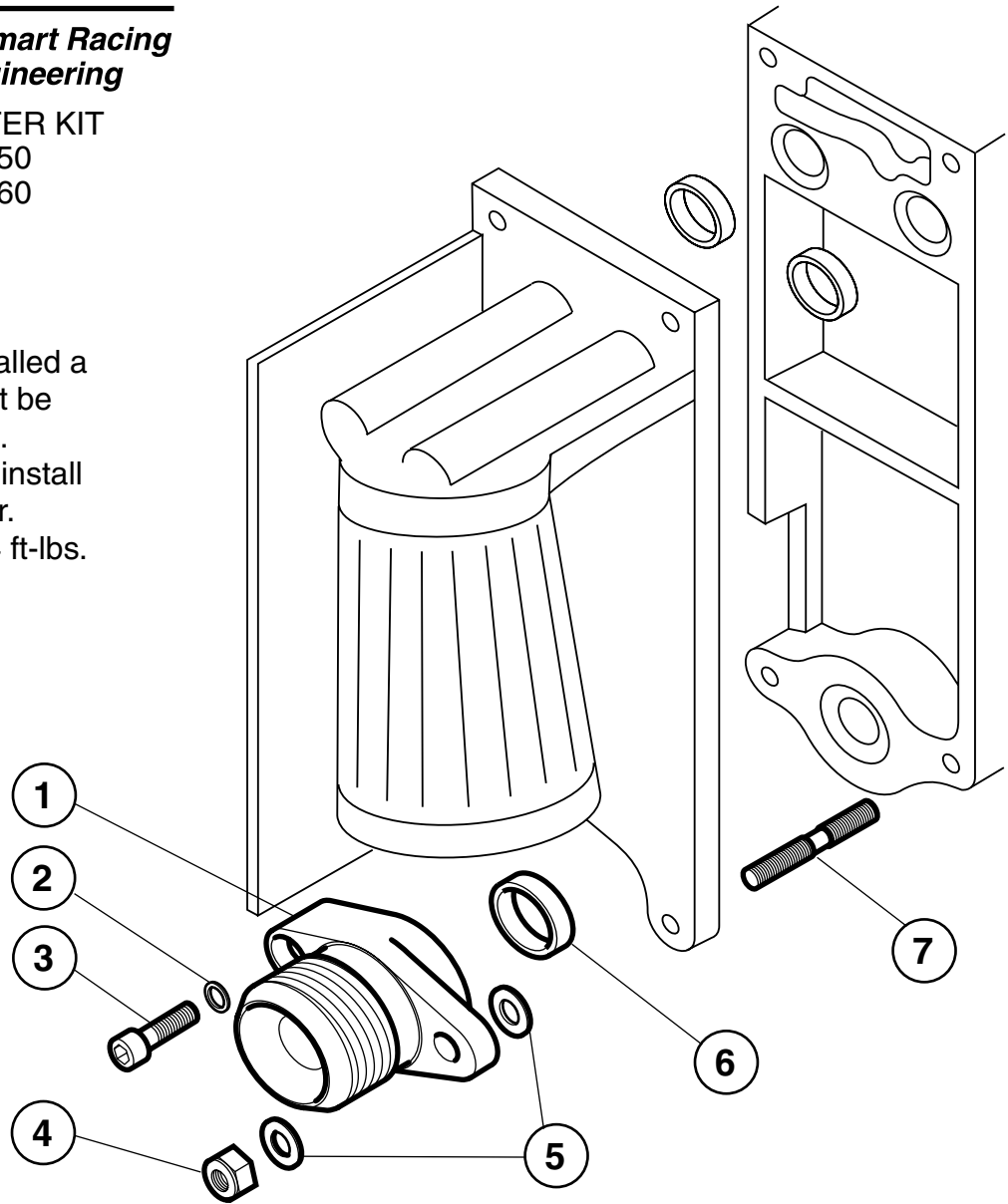

Item	SRP Part No.	Part Name	Quantity
1	155100	-16 Oil Inlet Adapter	1
-	155110	-20 Oil Inlet Adapter	1
2	431640	Schnar Washer	1
3	155314	20 mm Allen Bolt	1
4	155313	8mm Lock Nut	1
5	155312	8mm Wavy Washer	2
6	155212	Seal	1
7	155311	42mm Stud	1

Questions or comments please call 408.369.9997 or FAX 408.369.9741
www.smartracingproducts.com