

SMARTRACING™ PRODUCTS

A Company Developing Smart Racing
Products Through Engineering

993 OIL INLET ADAPTER KIT
-16 Part No. 155130
-20 Part No. 155140

993 OIL INLET ADAPTER KIT -16 Oil Line -20 Oil Line

Notes:

- 1) If oil filter plate is not installed a spacer ~10mm thick must be installed on the right stud.
- 2) We strongly suggest you install the oil filter plate and filter.
- 3) Torque all fasteners to 14 ft-lbs.

**Installation on a 964
requires machining
for the oil filter in
and out holes and
engine main inlet.**

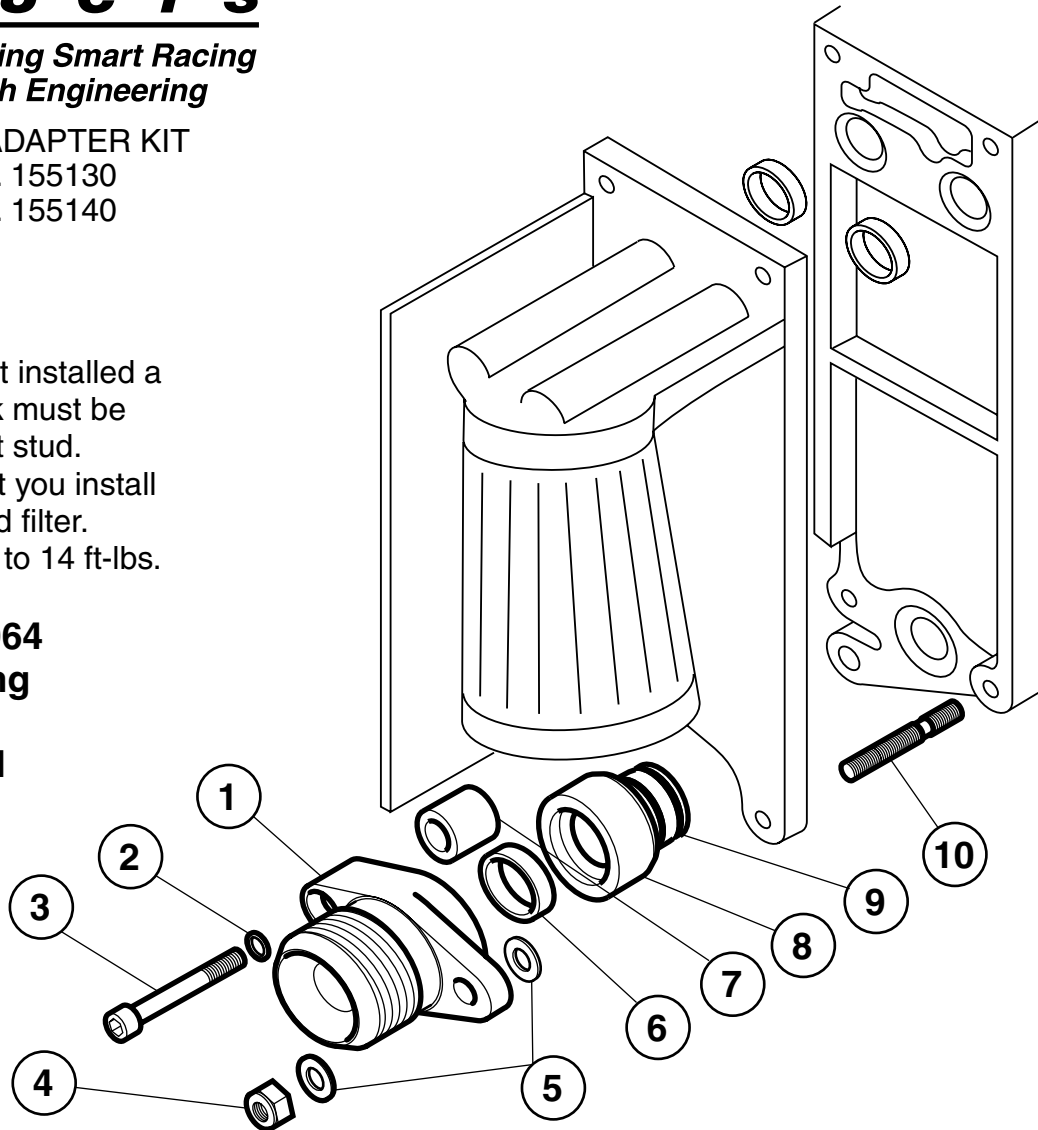

Item	SRP Part No.	Part Name	Quantity
1	155100	-16 Oil Inlet Adapter	1
-	155110	-20 Oil Inlet Adapter	1
2	431640	Schnar Washer	1
3	155316	40 mm Allen Bolt	1
4	155313	8mm Lock Nut	1
5	155312	8mm Wavy Washer	2
6	155212	Seal	1
7	155122	993 Spacer	1
8	155120	993 Adapter	1
9	155121	993 O-ring	2
10	155311	41mm Stud	1

Questions or comments please call 408.369.9997 or FAX 408.369.9741
www.smartracingproducts.com